

Method 17 Stainless Steel Filter Assembly #SFA-2590 Packing List

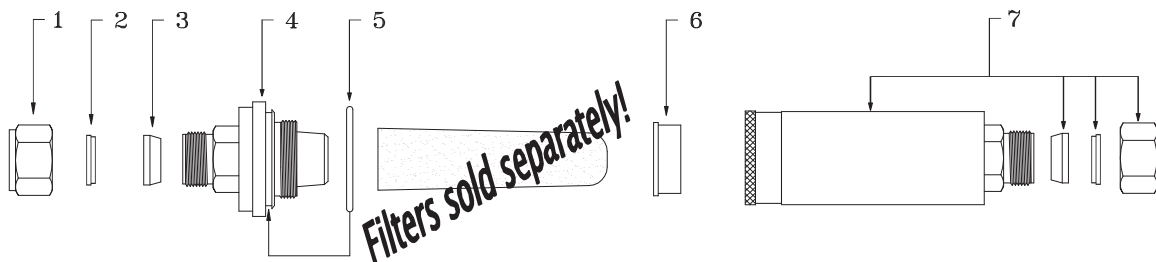

SFA-2590 Assembly Includes:

Ref No.	Part No.	Description	Quantity	Qty Shipped
1	N-10	Nut, 5/8" Tube, SS	2	
2	10FB-S	Back Ferrule, 5/8", Single, SS	2	
3	10FF-S	Front Ferrule, 5/8", Single, SS	2	
4	SFA-2590P16TPI	Inlet, SFA-2590, 5/8" Union, SS	1	
5	O-122V	O-ring, Viton, for the SFA-2590	3	
6	SFA-2590R1	Inner retainer ring for SFA-2590	1	
7	SFA-2590B	Body for SFA-2590, 5/8" Union, SS	1	

Reorder Information and Accessories:

Part #	Description
MPT-6-308	Extended Pitot Tip for Stainless Steel Thimble Filter Assemblies, 3/8" Tubing
O-122V	Viton O-Ring for SFA-2590 (500 F)
GF-2590	25 x 90mm Glass Fiber Filter Thimble-10/box (For SFA-2590)
GF-2590Q	25 x 90mm Quartz Fiber Filter Thimble-10/box (For SFA-2590)
GSB-250C	Glass Sample Bottle with Teflon™-Lined Lid, 250mL, Case of 12

Method 17 Stainless Steel Filter Assembly SFA-2590

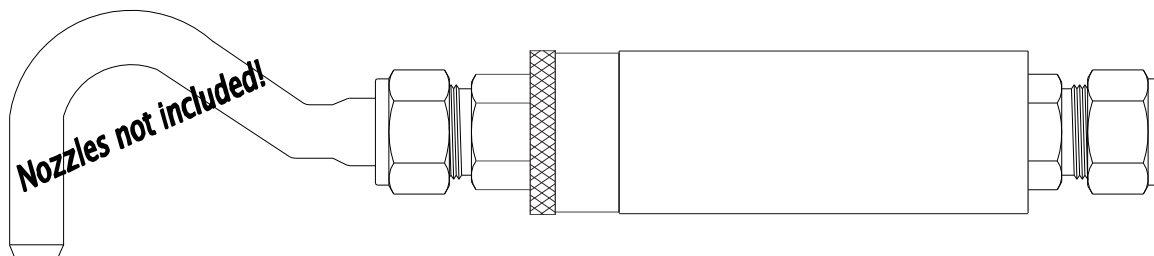

The USEPA Method 17 In-stack Filtration primary function is to remove the particulate at the stack temperature in order to address the variability with the greatest effect. Stack pressure has a negligible effect. Therefore particulate matter is withdrawn isokinetically from the source and collected in a glass fiber thimble filter maintained at stack temperature. The particulate mass is determined gravimetrically after removal of uncombined water.

The SFA-2590, Stainless Steel Filter Assembly, is designed to provide a positive seal against leakage from the outside or around the filter. The Thimble Filters are made of seamless Borosilicate Microglass fibers with an efficiency greater than 99.9% for 1 micron particles. We also offer Quartz Silica fiber thimble filters.

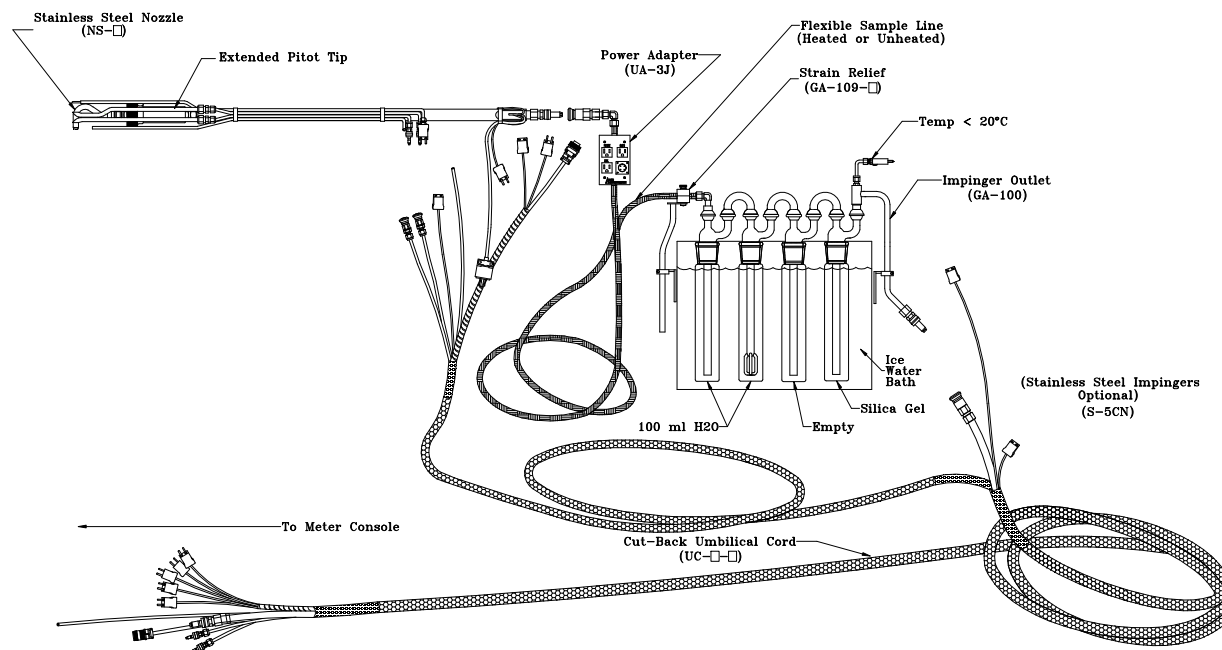

Flexible Method 17 Schematic